

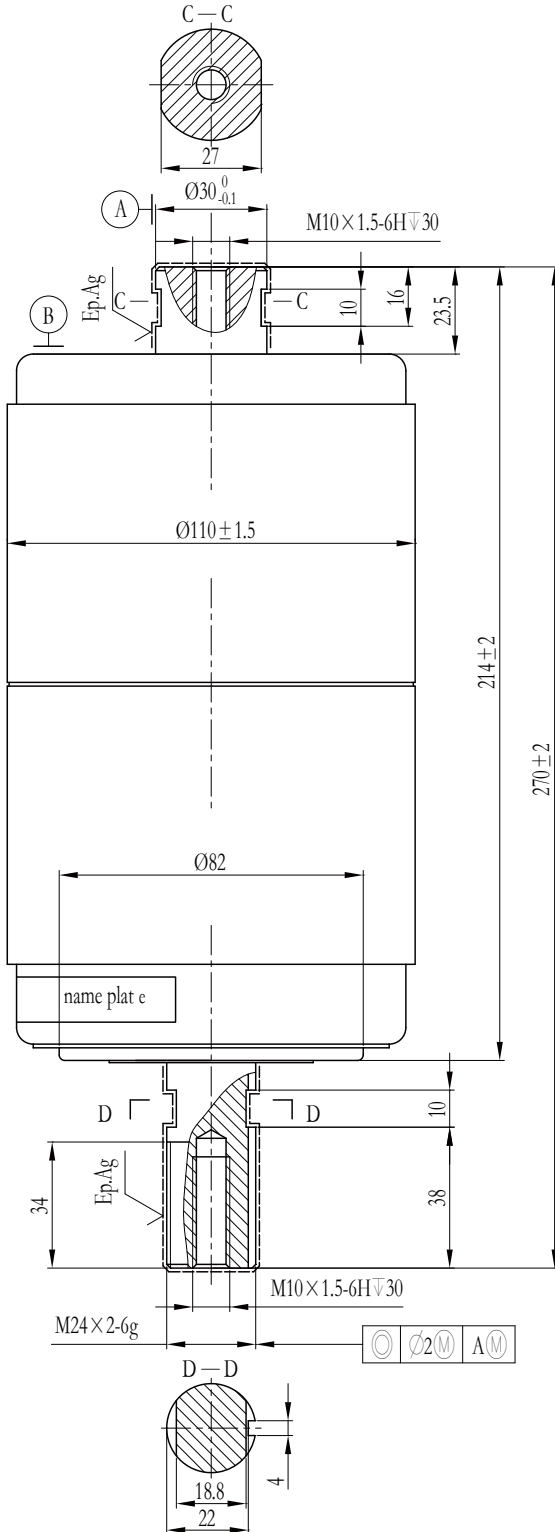

GTD-36/1250-25A



Main Technical Data		
Item	Unit	Value
Rated Voltage	kV	36
Lightning Impulse Withstand Voltage (Peak)	kV	170☆
Short-time (1min) Power-frequency Withstand Voltage	kV	42/70☆
Rated Frequency	Hz	60
Rated Current	A	1250
Rated Short-time Withstand Current	kA	25
Rated Duration of Short-circuit	s	3
Rated Peak Withstand Current	kA	63
Rated Short-circuit Making Current	kA	63
Rated Short-circuit Breaking Current	kA	25
Max. Dc Component		35%
Switch Operations of Rated Short-circuit Breaking Current	Operations	20
Rated Single Capacitor Bank Breaking Current	A	400※
Rated Back-to-Back Capacitor Bank Breaking Current	A	400※
Mechanical Endurance	Operations	10000
Clearance Between Open Contacts	mm	17 ± 1
Contact Closed Force Due to Bellows and Atmosphere	N	100 ± 40
Counterforce of Contact at Full Stroke	N	180 ± 30
Circuit Resistance at Min. Rated Contact Force	μΩ	≤ 25
Contact Limit Erosion	mm	3
Mass of Moving Parts	kg	1.2
Internal Gas Pressure	Pa	< 1.33 × 10 ⁻³
Shelf Life	Years	20
Rated Operating Sequence		Open-0.3s-CO-180s-CO

Mechanical Data of Switch Equipped With Interrupter		
Item	Unit	Value
Average Opening Speed (first 6mm)	m/s	1.6 ± 0.3
Average Closing Speed (last 6mm)	m/s	1.3 ± 0.3
Contact Bounce Duration at Closing Operation	ms	≤ 3
Out of Simultaneity of Contact Closing and Opening	ms	≤ 2
Rated Contact Pressure	N	2500 ⁺⁴⁰⁰ ₀
Contact Pressure at Contact Touch Point	N	1750 ⁺³⁰⁰ ₀
Max. Rebound of Contact at Opening Operation	mm	3
Overtravel During Opening	mm	≤ 2

Note 1: "☆" Within transformer oil or equivalent isolation medium;

Note 2: "※" Rated characteristics to be given on request;

Note 3: Meets or exceeds the electrical endurance requirements of class E2 for autoreclosing duty per IEC 62271-100;

Note 4: The movable stem of the vacuum interrupter could not suffer on more than 30N · m twisting force and in order not to damage the metal bellows, the movable stem should be prevented from rotation when assembling. For more requirements please check the Instructions of Usage.